

Wide Range Speakers High quality sound and availability for using indoor and outdoor.

LHA-30T / <LHA-15T>

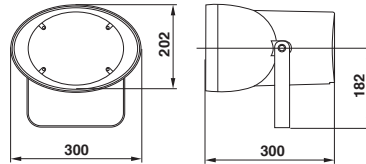

Uniquely designed speaker for both indoor and outdoor use with combined weather-endurance nearly equal to that of horn speaker and cone speaker's superb sound quality. LHA series are best suitable for use in arcades, amusement facilities, parking garages and BGM music service etc.



Rated input	30W 15W <LHA-15T>
Impedance	330/500/1kΩ (100V line) 670/1k/2kΩ (100V line) <LHA-15T>
SPL	101dB (1W/1m)
Frequency response	180Hz~15kHz 150Hz~15kHz <LHA-15T>
Finish	Baffle, Case(ABS resin): Light gray Bracket (Stainless steel): Light gray Punching net (Aluminum): Light gray
Mass	Approx. 3.3kg Approx. 2.7kg <LHA-15T>

JIS C 0920
IEC 60529 (IPX4)

LHA-6T



Uniquely designed speaker for both indoor and outdoor use with combined weather-endurance nearly equal to that of horn speaker and cone speaker's superb sound quality. LHA series are best suitable for use in arcades, amusement facilities, parking garages and BGM music service, etc.

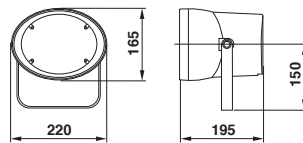

Rated input	6W
Impedance	1.7k/3.3k/10kΩ (100V line)
SPL	96dB (1W/1m)
Frequency response	150Hz~13kHz
Finish	Baffle, Case(ABS resin): Light gray Bracket (Stainless steel): Light gray Punching net (Aluminum): Light gray
Mass	Approx. 1.5kg

JIS C 0920
IEC 60529 (IPX4)

Special Speakers These speakers have special functions to use various place.

AH-181A

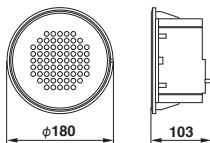

AH-181A is designed to stand against water and humidity from front. Possible to install humid place as bath room with one-touch.

Rated input	5W
Impedance	2k/3.3kΩ (100V line)
SPL	88dB (1W/1m)
Frequency response	80Hz~20kHz
Speaker	Φ120mm drip-proof dynamic cone speaker, 8Ω
Finish	(ABS resin): White
Mass	Approx. 750g

FR-230K

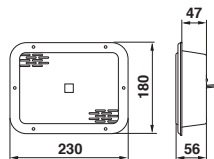

With super-slim body, FR-230K is designed for good performance at corrosion and weather proof. Possible to mount on the wall and ceiling of buses, trains.

Rated input	10W
Impedance	8Ω
SPL	100dB (1W/1m)
Frequency response	550Hz~5kHz
Finish	Horn, Reflector (Aluminum): Gray Panel (Steel sheet): Gray
Mass	Approx. 1.2kg

MA-15T

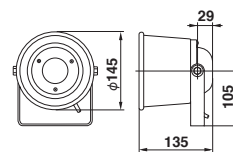

MA-15T is designed to stand against water and with salt-resistance, and good drainage.

Rated input	10W
Rated Impedance	1kΩ/2kΩ(100V line)
SPL	100dB (1W/1m)
Frequency response	500Hz~5kHz
Finish	Horn, Reflector (Aluminum): Light green Cover (Aluminum diecasting): Light green Bracket (Stainless steel): Light green
Mass	Approx. 1.6kg

Sono-column Speakers Wide range acoustic field can be produced from slim cabinet

SC-5JA

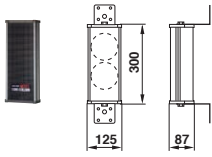

Rated input 5W
Impedance 8Ω
 2k/3.3k/10kΩ (100V line)
SPL 89dB (1W/1m)
Frequency response 200Hz~6kHz
Drivers Φ100mm dynamic cone speaker, 8Ωx 2
Finish Case (Extruded aluminum): Silver
 Punching metal (Steel sheet): Dark gray
 Top/Bottom lid (ABS resin): Light gray
Mass Approx. 1.3kg

SC-10JA

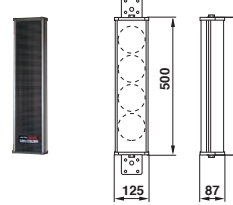

Rated input 10W
Impedance 8Ω
 1k/2k/5kΩ (100V line)
SPL 90dB (1W/1m)
Frequency response 200Hz~6kHz
Drivers Φ100mm dynamic cone speaker, 8Ωx 4
Finish Case (Extruded aluminum): Silver
 Punching metal (Steel sheet): Dark gray
 Top/Bottom lid (ABS resin): Light gray
Mass Approx. 2.2kg

SC-15JA

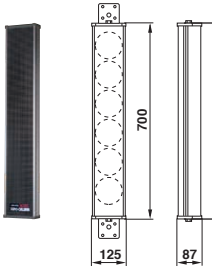

Rated input 15W
Impedance 8Ω
 670/1k/2kΩ (100V line)
SPL 91dB (1W/1m)
Frequency response 200Hz~6kHz
Drivers Φ100mm dynamic cone speaker, 8Ωx 6
Finish Case (Extruded aluminum): Silver
 Punching metal (Steel sheet): Dark gray
 Top/Bottom lid (ABS resin): Light gray
Mass Approx. 3.2kg

SC-20JA

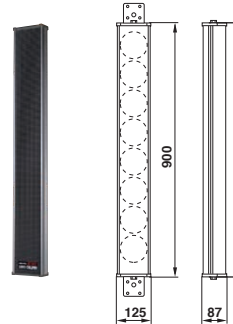

Rated input 20W
Impedance 8Ω
 500/670/1kΩ (100V line)
SPL 92dB (1W/1m)
Frequency response 200Hz~6kHz
Drivers Φ100mm dynamic cone speaker, 8Ωx 8
Finish Case (Extruded aluminum): Silver
 Punching metal (Steel sheet): Dark gray
 Top/Bottom lid (ABS resin): Light gray
Mass Approx. 4.0kg

SC-40A

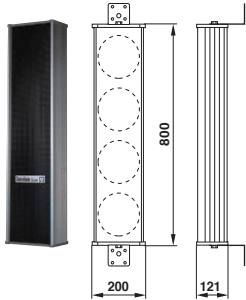

Rated input 20W
Impedance 8Ω
 500/670/1k/1.3kΩ (100V line)
SPL 95dB (1W/1m)
Frequency response 130Hz~10kHz
Drivers Φ160mm dynamic cone speaker, 8Ωx 4
Finish Case (Extruded aluminum): Silver
 Punching metal (Steel sheet): Black
 Top/Bottom lid (Aluminum diecasting): Light gray
Mass Approx. 7.0kg

SC-60A

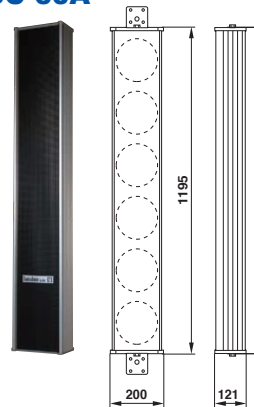

Rated input 30W
Impedance 8Ω
 330/500/670/1kΩ (100V line)
SPL 95dB (1W/1m)
Frequency response 130Hz~10kHz
Drivers Φ160mm dynamic cone speaker, 8Ωx 6
Finish Case (Extruded aluminum): Silver
 Punching metal (Steel sheet): Black
 Top/Bottom lid (Aluminum diecasting): Light gray
Mass Approx. 10.5kg

Matching Transformer

LT-35 / <LT-20>



Input 15~35W (100V line)
 5~20W (100V line) <LT-20>
Impedance 285/300/400/500/670 Ω
 500/670/1k/1.3k/2k Ω <LT-20>
Speaker 4/8/16 Ω
Mass Approx. 1.0kg
 Approx. 0.8kg <LT-20>

Cabinet Speakers Soft color tone cabinet enables to match various rooms.

CS-301L / <CS-303L>



Built-in speaker ensures high quality sound and superior acoustic efficiency, the cabinet speakers are used in space such as classroom and office.
CS-301L and CS-303L is Built-in attenuator type, which enable to be controlled the volume level in compliance with your need.

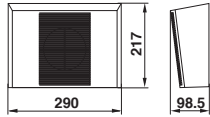

Rated input 1W
3W <CS-303L>
Impedance 10k Ω (100V line)
3.3k Ω (100V line) <CS-303L>
SPL 92dB (1W/1m)
Frequency response 150Hz~15kHz
Drivers Φ 120mm dynamic cone speaker, 8 Ω
Finish (ABS resin): Light gray
Mass Approx. 1.2kg

CS-303

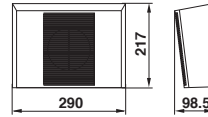

Rated input 3W
Impedance 3.3k/10k Ω (100V line)
SPL 92dB (1W/1m)
Frequency response 150Hz~15kHz
Drivers Φ 120mm dynamic cone speaker, 8 Ω
Finish (ABS resin): Light gray
Mass Approx. 1.2kg

CS-293 / <CS-295>



The large-sized matching transformer and the high quality speaker composed of the special paper cone and the powerful magnet enable to provide clear and stable sound.

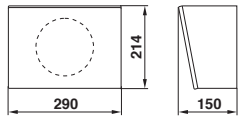

Rated input 3W
5W <CS-295>
Impedance 3.3k/10k Ω (100V line)
2k/4k Ω (100V line) <CS-295>
SPL 91dB (1W/1m)
Frequency response 100Hz~15kHz
Drivers Φ 160mm dynamic cone speaker, 8 Ω
Finish Cabinet (Wooden): Ivory
Baffle (Jersey net): Gray
Mass Approx. 2.0kg

CS-293LA / <CS-295LA>



CS-293LA and CS-295LA is bulid-in attenuator type.

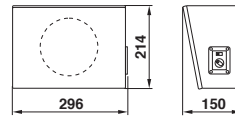

Rated input 3W/1W
5W <CS-295LA>
Impedance 3.3k/10k Ω (100V line)
2k Ω (100V line) <CS-295LA>
SPL 91dB (1W/1m)
92dB (1W/1m) <CS-295LA>
Frequency response 100Hz~15kHz
Drivers Φ 160mm dynamic cone speaker, 8 Ω
Finish Cabinet (Wooden): Ivory
Baffle (Jersey net): Gray
Mass Approx. 2.2kg

CS-289A



CS-289A, double-face speaker can produce clear and stable sound from both side. This speaker can be installed lengthwise and crosswise, it can be used at corridor and gangway etc.,.

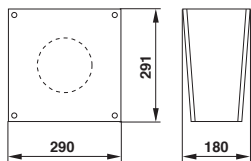

Rated input 6W / 2W
Impedance 1.7k/5k Ω (100V line)
SPL 91dB (1W/1m)
Frequency response 100Hz~15kHz
Drivers Φ 160mm dynamic cone speaker, 8 Ω x 2
Finish Cabinet (Wooden): Ivory
Baffle (Jersey net): Gray
Mass Approx. 3.1kg

Attenuators

AT-062B



Input capacitance 0.5~6W (100V line)
Finish (ABS resin): Ivory
Dimensions 48(W) x 110(H) x 54(D) mm
Mass Approx. 191g

AT-302B



Input capacitance 0.5~30W (100V line)
Finish (ABS resin): Ivory
Dimensions 48(W) x 110(H) x 54(D) mm
Mass Approx. 191g

AT-602B



Input capacitance 0.5~60W (100V line)
Finish (ABS resin): Ivory
Dimensions 48(W) x 110(H) x 54(D) mm
Mass Approx. 194g

Connectors

JX-114F



Connector XLR type plug (Male)
Finish (ABS resin): Ivory
Dimensions 48(W) x 110(H) x 39.3(D) mm
Mass Approx. 60g

JX-104F



Connector XLR type plug (Female)
Finish (ABS resin): Ivory
Dimensions 48(W) x 110(H) x 44.1(D) mm
Mass Approx. 70g

Panel for Connectors

PT-2SKA



Finish (Aluminum)
Dimensions 70(W) x 120(H) x 6.6(D) mm
Mass Approx. 22g

Floor Consent Box

JFB-200



Applicable connector XLR type plug
Finish Plate (Aluminum diecasting):
 Metallic silver
 Box (Steel plate): Black
Dimensions 179(W) x 149(H) x 158(D) mm
Mass Approx. 1.5kg

Spring-catch type Speakers Easy installation and panel selection from various type.

PR-176 / <PR-176L>

Spring catch type speaker require no screw for ceiling mounting.
One-touch terminal facilitates wiring work.
Possible to select input (W) by slide-switch.

Rated input 6W
Impedance 1.7/3.3/10kΩ (100V line)
SPL 95dB (1W/1m)
Frequency response 100Hz~12kHz
Driver Φ160mm dynamic cone speaker, 8Ω
Finish (ABS resin): Black
Mass Approx. 830g
Approx. 850g <PR-176L>

PR-176L built in attenuator type.

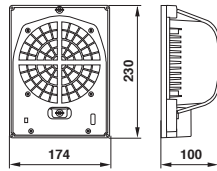

Panels for PR-176 / PR-176L

PL-233W



Finish Grill (ABS resin): White
Net (Expanded metal): White
Dimensions Φ230 mm
Mass Approx. 123g

PL-230W



Finish Grill (ABS resin): White
Net (Jersey): White
Dimensions Φ230 mm
Mass Approx. 130g

PL-230P



Finish Grill (ABS resin): Silver
Punching net (Aluminum): Silver
Dimensions Φ230 mm
Mass Approx. 120g

PL-230PW



Finish Grill (ABS resin): White
Punching net (Aluminum): White
Dimensions Φ230 mm
Mass Approx. 120g

PL-460W



Finish Grill (PS resin): White
Net (Jersey): White
Dimensions 230 x 230 mm
Mass Approx. 160g

PR-136 / <PR-136L>

Spring catch type speaker require no screw for ceiling mounting.
One-touch terminal facilitates wiring work.
Possible to select input (W) by slide-switch.

Rated input 6W
Impedance 1.7/3.3/10kΩ (100V line)
SPL 94dB (1W/1m)
Frequency response 120Hz~15kHz
Driver Φ120mm dynamic cone speaker, 8Ω
Finish (ABS resin): Black
Mass Approx. 740g
Approx. 760g <PR-136L>

PR-136L built in attenuator type.

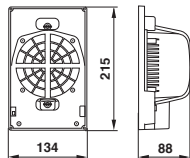

Panels for PR-136 / PR-136L

PL-183W



Finish Grill (ABS resin): White
Net (Expanded metal): White
Dimensions Φ180 mm
Mass Approx. 65g

PL-181W



Finish Grill (ABS resin): White
Net (Jersey): White
Dimensions Φ180 mm
Mass Approx. 65g

Exposed type Speakers

SP-233 / <SP-233LA>

SP series are exposed type speaker with round shape, suitable to mount on the concrete ceiling of underground parkings and elevators.
SP-233LA is built-in attenuator type.

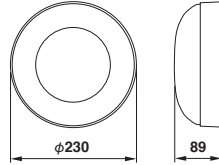

Rated input	3W 3W/1W <SP-233LA>
Impedance	3.3k/10kΩ (100V line)
SPL	93dB (1W/1m)
Frequency response	140Hz~16kHz
Drivers	Φ160mm dynamic cone speaker, 8Ω
Finish	Body(ABS resin): White Net(SECC): Light gray
Mass	Approx. 880g Approx. 890g <SP-233LA>

PS-311L

PS series can deliver clear-cut enunciation sound with low-distortion, and are used acoustic fiber board which enable to prevent acoustic diffusion.
Simple design can match various places such as modern architecture, office buildings etc.
PS-311L is built-in attenuator type.

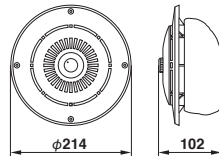

Rated input	3W
Impedance	3.3kΩ (100V line)
SPL	92dB (1W/1m)
Frequency response	90Hz~12kHz
Drivers	Φ160mm dynamic cone speaker, 8Ω
Finish	(ABS resin): Half-matted Ivory white
Mass	Approx. 700g

PS-300

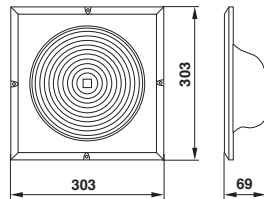

Rated input	3W
Impedance	3.3k/5k/10kΩ (100V line)
SPL	93dB (1W/1m)
Frequency response	80Hz~12kHz
Drivers	Φ160mm dynamic cone speaker, 8Ω
Finish	(PS resin): White
Mass	Approx. 1.0kg

PS-315LG

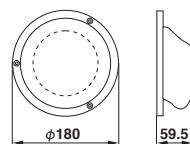

Rated input	3W
Impedance	3.3k/5k/10kΩ (100V line)
SPL	93dB (1W/1m)
Frequency response	120Hz~12kHz
Drivers	Φ120mm dynamic cone speaker, 8Ω
Finish	Grill (Aluminum): Stainless color Net (Jersey): Light gray
Mass	Approx. 540g